

6th Annual *Help Me Grow* National Forum

# *Reaching New Heights*

## FORUM AGENDA

April 15-17, 2015



ORANGE COUNTY, CA

 Help Me Grow<sup>®</sup>  
National Center

# Hilton Orange County

Costa Mesa

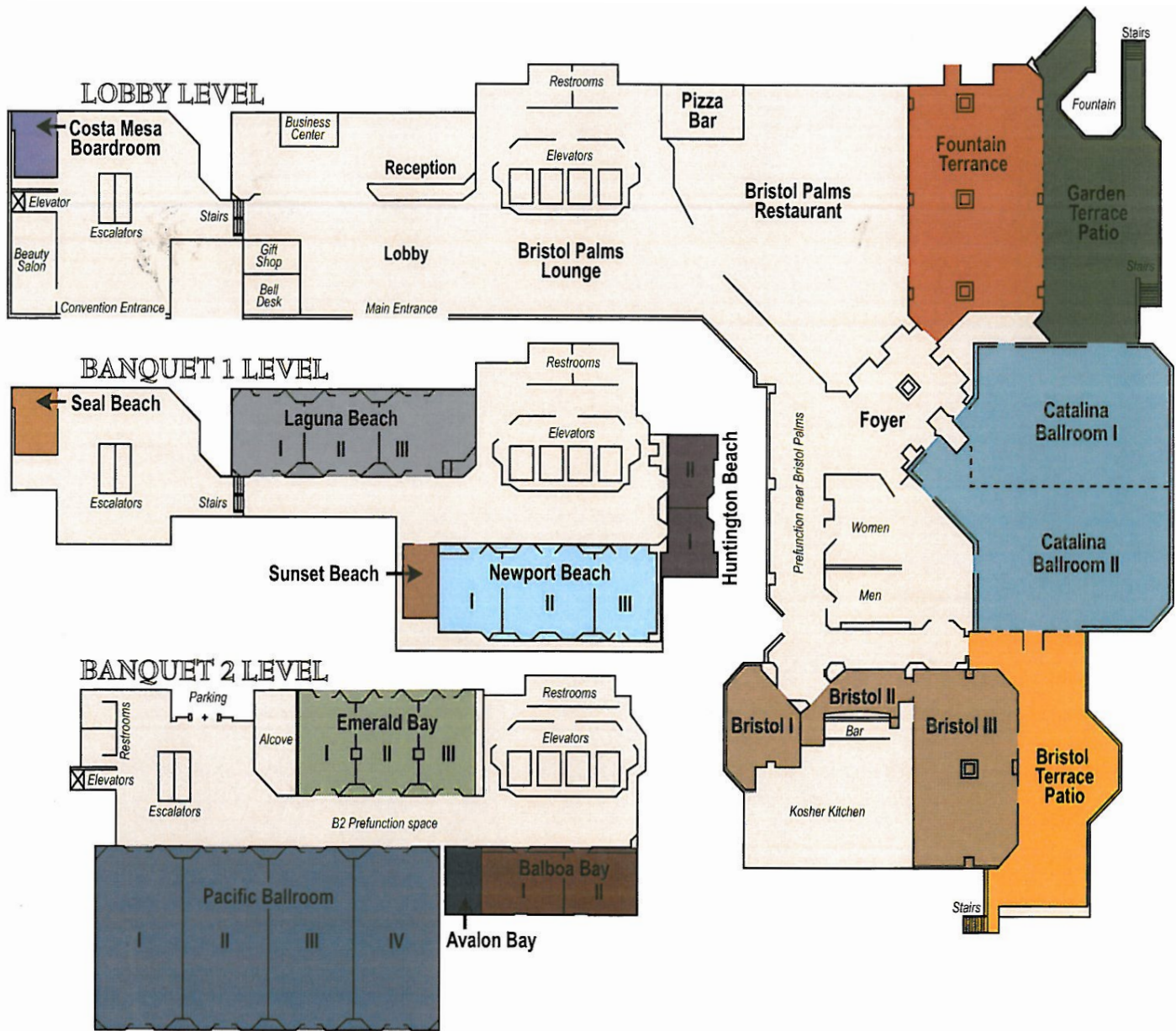

# Welcome to the *Help Me Grow* National Forum!

## CONTENTS

Hotel Map.....	2
Forum Agenda	
<i>Wednesday, April 15</i> .....	4
<i>Thursday, April 16</i> .....	6
Breakout Session 1.....	8
Breakout Session 2.....	11
<i>Friday, April 17</i> .....	14
<i>Help Me Grow</i> National Team.....	15
Forum Planning Committee.....	15



## **WEDNESDAY APRIL 15**

### OPTIONAL SITE VISITS

12:30 - 2:30 p.m.

---

#### **Help Me Grow Call Center at 2-1-1 Orange County**

Visit our call center and learn about the partnership between *Help Me Grow* and 2-1-1 Orange County. Site visit will include tour, overview of shared resource database and panel discussion with our Care Coordinators. *Bus loading from hotel at 11:45 a.m.*

1 - 3 p.m.

---

#### **Help Me Grow in Early Care & Education**

Visit an early education site at a local community college and learn how we have embedded *Help Me Grow* care coordination and connection to services for the children enrolled in the Child Signature Program-3 and Early Head Start. *Bus loading from hotel at 12:15 p.m.*

1:30 - 3:30 p.m.

---

#### **Orange County Connection Café**

Experience the Orange County version of a networking breakfast. As a participant, you'll become familiar with the design and content of a Connection Café and receive historical information on past events. *Newport Beach*

### REGIONAL NETWORKING

4 - 5 p.m.

---

#### **EASTERN REGION—Laguna Beach 1**

CT, DE, MA, NJ, NY, VT

##### **Facilitators**

Luz Rivera, CT

Ericka Williams, NJ

#### **SOUTHEASTERN REGION—Laguna Beach 2**

AL, D.C., FL, KY, LA, SC, P.R., WV

##### **Facilitators**

Jane Witowski, SC

Gail Piggott, AL

#### **CENTRAL REGION—Newport Beach 1**

IA, MI, MN, MO

##### **Facilitators**

Donna Lackie, MI

Rebecca Goldsmith, IA

#### **WESTERN REGION—Newport Beach 2**

AK, CA, CO, OR, UT, WA, WY

##### **Facilitators**

Cindy Reed, CA

Julie Miller, UT

# **WEDNESDAY APRIL 15**

## OPENING SESSION

5:30 p.m.

---

### **Welcome & Introductions**

Paul Dworkin, *Founder, Help Me Grow*

Joanna Bogin, *Director, Help Me Grow National Center*

*Catalina Ballroom 1*

6 p.m.

---

### **Orange County, CA, Presentation**

Joseph H. Donnelly, *Medical Director, Help Me Grow Orange County*

Rebecca Hernandez, *Program Manager, Help Me Grow Orange County*

Christina Altmayer, *Executive Director, Children & Families Commission of Orange County*

6:30 p.m.

---

### **Keynote** “About breakfast and other things to learn from *Help Me Grow*”

Ed Schor, *Senior Vice President, Programs and Partnerships,*

*Lucille Packard Foundation for Children’s Health*

7 p.m.

---

### **Dinner**

### **Networking**

*Fountain Terrace*

### **Dessert**

*Garden Terrace*



## **THURSDAY APRIL 16**

7:45 a.m.

---

### **Breakfast**

#### **Early Bird Networking**

*Fountain & Garden Terraces*

8:30 a.m.

---

### **Welcome**

#### **Celebrating Successes**

*Help Me Grow* affiliates talk about their successes and growth

Patsy Hampton, *Program Manager, Help Me Grow California*

Jane Witowski, *Manager, Help Me Grow South Carolina*

Barbara Leavitt, *Director, Help Me Grow Utah*

Janae Moss, *Parent Champion, Help Me Grow Utah*

*Catalina Ballroom 1*

9:15 a.m.

---

#### **Keynote** “Lessons from ‘Down Under’ in Early Childhood System Building”

Frank Oberklaid, *Founding Director, Centre for Community Child Health,*

*The Royal Children’s Hospital Melbourne, Professor of Paediatrics, University of Melbourne*

*Catalina Ballroom 1*

10 a.m.

---

### **BREAK**

10:15 a.m.

---

#### **Breakout Session 1 (see pages 8-10)**

11:45 a.m.

---

### **Lunch**

*Fountain Terrace*

## ***THURSDAY APRIL 16***

1 p.m.

---

**Keynote** “Balancing ACES with HOPE” (Health Outcomes from Positive Experiences)

Robert Sege, *Senior Fellow, Center for the Study of Social Policy,  
Vice President, The Medical Foundation Division, Health Resources in Action*

*Catalina Ballroom 1*

1:45 p.m.

---

**Common Indicators**

Sara Sibley, *Manager, Help Me Grow National Center*

*Catalina Ballroom 1*

2 p.m.

---

**Diffusion of Innovation**

Paul Dworkin, *Founder, Help Me Grow*

**Response to remarks**

Todd Klunk, *Project Officer, W.K. Kellogg Foundation*

*Catalina Ballroom 1*

2:45 p.m.

---

**Breakout Session 2 (see page 11-13)**

4:15 p.m.

---

**Networking**

5 p.m.

---

**Leave for reception**

*(meet in Hotel main lobby)*



# **THURSDAY APRIL 16** BREAKOUT SESSION 1

10:15 – 11:45 a.m.

---

## **1:1 – Encourage and Support Authentic Parent Engagement**

*Laguna Beach 1*

Come and hear from *Help Me Grow* parent advocates in three states. The Velasco Family, *HMG* Orange County Family Champions, will share their experiences; Janae Moss, *HMG* Utah Family Champion will describe her work in establishing *HMG* parent support groups and forming a parent council in Utah; Juno Duenas, San Francisco, CA, will talk about Support for Families work regarding parent engagement. A group discussion on the successes and barriers to establishing authentic family engagement in your state will be included.

*PRESENTERS*

**Gabriela and Pedro Velasco**, *Help Me Grow* Orange County Parent Champions

**Janae Moss**, *Help Me Grow* Utah Parent Champion

**Juno Duenas**, Executive Director Support for Families San Francisco, California

## **1:2 – How Could a Care Coordination Collaborative Enhance Your *Help Me Grow* System?**

*Laguna Beach 2*

The benefits of Care Coordination Collaboratives include improved communication, increased understanding of referral sources, efficiency in making referrals, and identification of system's barriers. This session offers an opportunity for affiliates that are interested in or currently working on establishing a Collaborative to discuss their efforts and challenges.

*PRESENTERS*

**Marijane Carey**, Carey Consulting

**Susan Roman**, Director, Special Kids Support Center,  
Connecticut Children's Medical Center

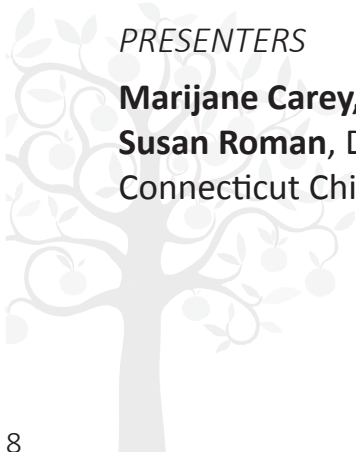



# **THURSDAY APRIL 16** BREAKOUT SESSION 1

10:15 – 11:45 a.m.

---

## **1:3 – Engaging Child Health Providers in *Help Me Grow*: 3 Great New Ideas**

*Laguna Beach 3*

Outreach to child health providers is a critical component of *Help Me Grow* systems. Presenters will discuss new approaches to engaging child health providers in developmental surveillance, screening and using *HMG*. Utah’s work to meet the needs of urban and rural practices will be reviewed as well as their efforts to meet practice needs identified at visits. For states that are home to pediatric residency and nurse practitioner training programs, *HMG* Utah staff will also discuss an innovative program that introduces *HMG* to future child health providers and works with them through an actual call. An update on the Office for Community Child Health Maintenance of Certification (MOC) program will be provided along with lessons learned from states and providers that have participated in the *HMG* MOC program.

*PRESENTERS*

**Lisa Honigfeld**, Vice President for Health Initiatives, Child Health & Development Institute  
**Eminet Abebe Gurganus**, Program Manager, Innovations and Maintenance of Certification, Office for Community Child Health  
**Robin Lindsay**, *Help Me Grow* Child Development Specialist, *Help Me Grow* Utah

## **1:4 – Dancing with Data: Analyzing, Visualizing & Utilizing Developmental Data to Drive Support**

*Newport Beach 2*

Presenters will provide an overview of the development and implementation of the *Help Me Grow* Michigan Project which will demonstrate the use of over 50,000 ASQ screenings to highlight successes at the short-term, intermediate, and long-term levels. Team will share visualizing examples of data at child, program and community levels along with examples of creative data driven supports. Project Evaluation team will share findings for longitudinal impacts, targeting high risk communities and utilizing data for community planning and impact.

*PRESENTERS*

**Lisa Sturges**, Great Start Macomb Coordinator  
**Cynthia Schellenbach**, Associate Professor Oakland University  
**Donna Lackie**, *Help Me Grow* Michigan Project Administrator

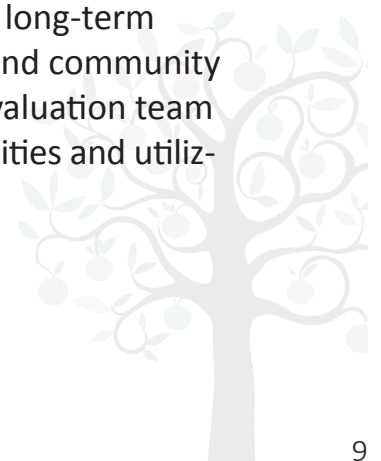

# **THURSDAY APRIL 16** BREAKOUT SESSION 1

10:15 – 11:45 a.m.

---

## **1:5 – Weaving Lessons: Pulling Together Your State’s Early Childhood Threads**

*Newport Beach 3*

Learn how New Jersey, South Carolina and Vermont use national initiatives to support *Help Me Grow* system building. Examples of how to leverage and align with several national initiatives will be provided including: Maternal, Infant, and Early Childhood Home Visiting (MIECHV), Early Childhood Comprehensive Systems (ECCS), Substance Abuse and Mental Health Services Administration’s (SAMHSA) Project LAUNCH (Linking Actions for Children’s Unmet Needs), Early Learning Challenge-Race to the Top (ELC- RTT), Maternal and Child Health Bureau State Implementation Grant Program (D70), and Governor’s Early Childhood Advisory Councils. Whether your State has one or several of these initiatives or not, please come, learn from and contribute to this interactive session!

### *PRESENTERS*

**Eric Bellamy**, MIECHV Program Manager, Children’s Trust, South Carolina

**Rosemary Wilson**, South Carolina Department of Health and Environmental Control, MCH, ECCS Coordinator

**Janet Kilburn**, Child Development Coordinator & Act Early Ambassador, Maternal and Child Health, Vermont Department of Health, Burlington, VT

**Ericka Williams**, New Jersey Department of Children and Families, Early Childhood Comprehensive Systems/*Help Me Grow* NJ Coordinator

## **1:6 – Help Me Grow 101**

*Newport Beach 1*

This session is a basic introduction for those new to *Help Me Grow*. Did you recently join a *Help Me Grow* team? Are you a pre-affiliate? Want to learn more about fidelity to the model? Common Indicators? What resources are available? Come, ask questions and meet new partners from the *Help Me Grow* community.

### *PRESENTER*

**Joanna Bogin**, Director, *Help Me Grow* National Center, Connecticut Children’s Medical Center

## **THURSDAY APRIL 16** BREAKOUT SESSION 2

2:45 – 4:15 p.m.

---

### **2:1 – The Mid-level Developmental Assessment (MLDA) Innovative Model**

*Laguna Beach 1*

Learn how MLDA can support early and comprehensive assessments in your state and how you can join the next cohort. This session gives a brief overview of the MLDA model, what it is, why it's needed, and how it is being piloted in Vermont. Highlights of the first cohort experience are shared along with information about the technical assistance provided for MLDA diffusion and implementation.

*PRESENTERS*

**Susan E Vater**, MLDA Consultant, Village for Families and Children, Hartford CT  
**Janet Kilburn**, Child Development Coordinator & Act Early Ambassador,  
Maternal and Child Health, Vermont Department of Health, Burlington, VT

### **2:2 – Understanding the Complexity of “Concrete Support in times of Need”**

*Newport Beach 3*

Using the Strengthening Families Framework to measure and improve impact. The Strengthening Families Framework offers many tools to measure organizational and individual impact when building the Protective Factors. We will exam how survey and program participation data informs our current work and future implementation.

*PRESENTERS*

**Linda Nguyen**, Program Manager, Orange County Department of Education  
**Barbara Leavitt**, State Director, *Help Me Grow* Utah, United Way of Utah County



## **THURSDAY APRIL 16** BREAKOUT SESSION 2

2:45 – 4:15 p.m.

---

### **2:3 – Tool Box Resources for Care Coordinators: Protective Factors and Trauma-Informed Care**

*Newport Beach 1*

Today many families who contact *Help Me Grow* call centers are dealing with toxic stress and/or the impact of a traumatic event. Learn how utilizing the protective factors and offering trauma informed care coordination can support and empower families. This session will review and discuss:

1. the definitions of toxic stress and psychological trauma;
2. the protective factors and components of trauma informed care; and
3. strategies for supporting care coordinators in utilizing these tools.

As a continuation of Dr. Bob Sege’s keynote presentation, he will join this breakout session and contribute his knowledge and expertise to the discussion.

*PRESENTERS*

**Marijane Carey**, Carey Consulting

**Jessica Rios**, Senior Care Coordinator, United Way of Connecticut

**Robert Sege**, Senior Fellow, Center for the Study of Social Policy,  
Vice President, The Medical Foundation Division, Health Resources in Action

### **2:4 – Continuous Quality Improvement (CQI) and *Help Me Grow***

*Newport Beach 2*

Learn the tools to start and/or enhance CQI in your *Help Me Grow* system. This session will include strategies for beginning CQI, examples of how *Help Me Grow* affiliates have implemented CQI processes, and helpful tools that will assist with the Quality improvement process. There will also be an opportunity for questions and discussion on this topic.

*PRESENTER*

**MaryCatherine Arbour**, Associate Physician for Research, Division of Global Health Equity, Department of Medicine, Brigham and Women’s Hospital

## **THURSDAY APRIL 16** BREAKOUT SESSION 2

2:45 – 4:15 p.m.

---

### **2:5 – Health, Equity, & Young Children: From Exemplary Practice to Exemplary Policy**

*Laguna Beach 3*

As *Help Me Grow* and other pediatric innovations develop at the community level to better respond to the P.A.R.E.N.T.S. science (**P**rotective factors, **A**dverse childhood experiences, **R**esiliency, **E**pigenetics, **N**eurobiology, **T**oxic stress, and **S**ocial determinants of health), state lawmakers also are grappling with how to best use this science to improve the healthy development of children and close disparities in health and learning. With a focus on Iowa’s efforts to provide state financing for its *Help Me Grow* program (1st Five), this session will discuss the need and opportunity for policy education, messaging, and advocacy with lawmakers to further promote policies and investments that expand *Help Me Grow* and other needed services to address the P.A.R.E.N.T.S. science. Charles Bruner and Mary Nelle Trefz will lead this workshop, representing CFPC and the BUILD Initiative’s “Health Equity and Young Children” Learning Center and Collaborative Innovation Network (CoIN).

*PRESENTERS*

**Charles Bruner**, Executive Director, Child and Family Policy Center

**Mary Nelle Trefz**, Health Policy Associate, Child and Family Policy Center

### **2:6 – Bringing *Help Me Grow* to Life**

*Laguna Beach 2*

Join three states, Alabama, California & Connecticut and learn about creative tools and efforts to outreach to families and the community. Outreach methods will highlight; Books, Balls & Blocks, Connection Cafés, the *Help Me Grow* Connecticut campaign and ASQ activities as ways to connect families to services. This session will also include a discussion on strategies for marketing and outreach to families.

*PRESENTERS*

**Katie Naman**, *Help Me Grow* Alabama Coordinator

**Deborah Watson**, Consultant, *Help Me Grow* Connecticut, CT Office of Early Childhood

**Deanna Parga**, Child Development Community Liaison, *Help Me Grow* Orange County

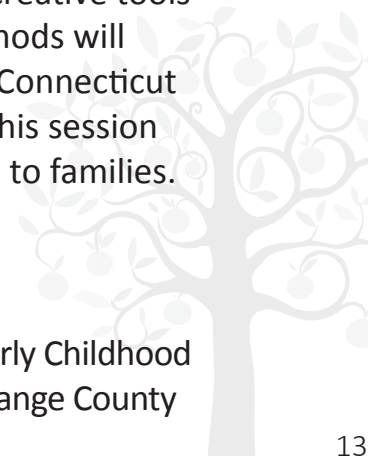

## **FRIDAY APRIL 17**

7:45 a.m.

---

**Breakfast  
Early Bird Networking**

*Fountain & Garden Terraces*

8:30 a.m.

---

**Help Me Grow National Update**

Joanna Bogin, *Director, Help Me Grow National Center*

*Catalina Ballroom 1*

9 a.m.

---

**Keynote** “*Help Me Grow & Home Visiting Partnership: A Strategic Vision in Support of Young Children’s Healthy Development*”

David Willis, *Director, Division of Home Visiting and Early Childhood Systems, Maternal & Child Health Bureau*

*Catalina Ballroom 1*

9:30 a.m.

---

**“Continuous Quality Improvement in Help Me Grow Systems”**

MaryCatherine Arbour, *Associate Physician for Research, Division of Global Health Equity, Department of Medicine, Brigham and Women’s Hospital*

*Catalina Ballroom 1*

10 a.m.

---

**Break**

*Garden Terrace*

10:15 a.m.

---

**World Café**

*Catalina Ballroom 1*

12 p.m.

---

**Networking Lunch  
& State Meetings**

*Fountain & Garden Terraces*

1:30 p.m.

---

**States Report Out**

*Catalina Ballroom 1*

2:30 p.m.

---

**Closing Remarks**

Paul Dworkin

*Founder, Help Me Grow*

*Catalina Ballroom 1*

## **HELP ME GROW** FORUM PLANNING COMMITTEE

*Enormous thanks to the Committee for their eight months of dedicated, tireless effort to make this 2015 Forum the best it could possibly be.*

Jennifer Safstrom (FL)

Rebecca Goldsmith (IA)

Diana Koonce (KY)

Ericka Williams (NJ)

Holly Mar-Conte (OR)

Lisa Soenen (SC)

Julie Miller (UT)

Kelly Smith (WA)

Linda Shaffer (WV)

### California Forum Planning Committee Members

Rebecca Hernandez (HMG Orange County)

Patsy Hampton (HMG State Coordinator)

Cindy Reed (HMG Ventura County)

Debbi Davis (HMG Solano County)

## **HELP ME GROW** NATIONAL CENTER

Paul Dworkin, Founder

Joanna Bogin, Director

Sara Sibley, Manager

Lindsay Haythorn, Administrative Assistant

*Thank you to the Office of Community Child Health team at Connecticut Children's Medical Center in Hartford, Connecticut.*

Supported in part by a generous grant from the W.K. Kellogg Foundation

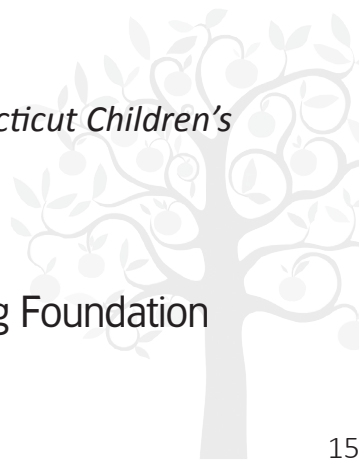

# **HELP ME GROW NATIONAL FORUM** 2015 SPONSORS



**Help Me Grow**  
ORANGE COUNTY



**FIRST 5**  
ASSOCIATION  
OF CALIFORNIA



Children & Families  
Commission of Orange County

Connecticut Children's  
*Office for Community Child Health*



THE CENTER FOR AUTISM  
& NEURODEVELOPMENTAL DISORDERS

**UC Irvine**  
Department of Pediatrics



**Help Me Grow**  
California



Graphic design by Becky Karush  
[www.beckykarush.com](http://www.beckykarush.com)

*Help Me Grow National Center*

282 Washington Street  
Hartford, CT 06106

860-837-6232

[info@helpmegrownational.org](mailto:info@helpmegrownational.org)  
[www.HelpMeGrowNational.org](http://www.HelpMeGrowNational.org)